

WKE45 SUPER COBALT HSS TOOL BITS

RECTANGULAR		
B A Size	L Overall Length	Net Price Each
1/8x5/8"	6"	36.45
3/16x5/16	4	24.47
1/4x3/8	2½	19.16
1/4x3/8	4	21.89
1/4x1/2	3	20.68
1/4x1/2	4	22.52
1/4x1/2	6	36.74
1/4x3/4	5	40.23
1/4x3/4	6	43.27
1/4x1	6	73.54
5/16x7/16	4	34.94
5/16x1/2	3	25.97
5/16x1/2	6	52.00
5/16x3/4	5	91.79
5/16x1	6	92.32
3/8x1/2	3	31.44
3/8x1/2	4	38.15
3/8x1/2	6	46.96
3/8x5/8	4	41.05
3/8x5/8	5	47.17
3/8x5/8	6	48.57
3/8x3/4	4	44.88
3/8x3/4	5	52.71
3/8x3/4	6	55.68
3/8x1	6	102.87
1/2x3/4	4	50.44
1/2x3/4	5	55.65
1/2x3/4	6	68.89
1/2x1	7	106.33
1/2x1¼	7	184.92
1/2x1½	7	219.63
5/8x3/4	5	100.51
5/8x7/8	6	182.39
5/8x1	7	178.80
5/8x1¼	7	221.67
3/4x1	6	180.45
3/4x1¼	6	218.00

METRIC RECTANGULAR		
B A Size	L Overall Length	Net Price Each
3x12mm	90mm	19.01
3x12	200	39.30
4x10	100	23.34
4x16	160	43.85
4x16	200*	47.16
4x20	200*	49.34
5x20	200*	62.82
6x8	70	19.12
6x10	200	50.73
6x12	200	54.71
6x14	140	41.85
6x20	200*	77.13
8x12	160	51.79
8x12	200	62.77
8x16	140	54.91
8x16	160*	55.91
8x16	200*	71.28
8x20	200*	103.59
10x12	200	72.62
10x14	80	36.04
10x14	200*	72.88
10x16	160	70.37
10x16	200	88.88
10x20	160	84.73
10x20	200	97.41
10x40	200*	191.75
12x16	200	94.39
12x25	200*	108.12
12x30	200*	140.82
14x20	200*	118.54
16x20	200	140.55
20x25	200*	218.21

SQUARE		
Size Square	L Overall Length	Net Price Each
3/16"	2½"	9.02
3/16	4	15.02
1/4	2½	10.04
1/4	4	16.11
1/4	6*	23.83
1/4	8*	30.16
5/16	2½	11.76
5/16	3	14.20
5/16	4	18.96
5/16	6	28.41
5/16	8	47.64
3/8	3	15.94
3/8	4	21.09
3/8	6	31.61
3/8	8	56.14
7/16	3½	32.62
1/2	4	29.20
1/2	6	43.67
1/2	8	80.67
5/8	4½	51.05
5/8	6	94.34
3/4	5	72.86
3/4	6	87.47
1	5½	192.28
1	8	274.02

METRIC SQUARE		
Size Square	L Overall Length	Net Price Each
4mm	63mm	9.21
4	100	15.94
5	63	8.87
5	160	24.56
6	63	11.49
6	100	19.01
6	160	27.38
6	200	32.85
7	200	35.12
8	63	15.89
8	100	25.26
8	160	26.40
8	200	39.50
10	125	35.84
10	160	37.79
10	200	47.28
12	100	39.71
12	160	42.90
12	200	53.44
14	100	54.18
14	160	80.24
14	200*	78.79
16	100*	65.96
16	160	101.47
16	200*	111.45
18	200*	152.28
20	160*	154.08
20	200	188.98
25	200*	264.68

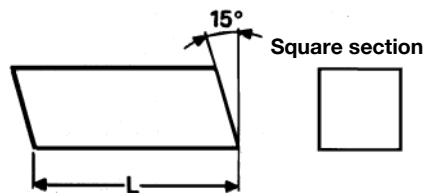

*** AVAILABLE UNTIL STOCK IS EXHAUSTED**

All Toolbits can be custom ground to meet your requirements

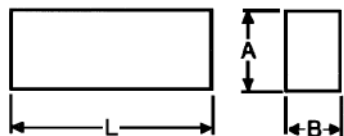

WKE45 TYPICAL ANALYSIS					
C	Cr	Mo	W	V	Co
1.40	4.2	3.5	9.0	3.5	11.0

SEE PAGE 13 FOR
WKE45 ROUND BLANKS

WILLIAM T. HUTCHINSON CO.

TOLL FREE 1-800-544-7934 • 453 LEHIGH AVENUE • UNION, NEW JERSEY 07083-7928

www.hssblanks.com

SQUARE & FLAT FORM TOOL BITS

**Square - Ground
High Speed Tool Bits**
Tolerance on Width and
Thickness ±.002
Ends Beveled 10°



SIZE	M2 R/C 64.5-66	M3 * R/C 65-66.5	M42 R/C 67-69	M34 R/C 65-67	T15PM R/C 65-67	PM M-48 R/C 65-67
1/8 sq. x 21/2"	9.40	9.93	9.70	9.62	12.93	8.14
3/16 sq. x 21/2"	5.11	5.32	5.54	5.40	7.28	7.86
1/4 sq. x 21/2"	6.51	5.80	6.94	6.08	8.04	9.13
5/16 sq. x 21/2"	7.86	6.49	8.50	7.02	9.45	14.59
3/8 sq. x 3"	8.84	—	10.04	9.70	12.97	18.47
7/16 sq. x 31/2"	11.44	11.02	12.99	12.83	17.07	24.43
1/2 sq. x 4"	15.36	15.28	18.19	17.94	24.05	35.16
5/8 sq. x 41/2"	23.00	23.27	28.08	27.63	37.54	53.80
3/4 sq. x 5"	32.77	36.69	44.76	44.07	59.41	82.53
7/8 sq. x 6" *	54.04	58.65	—	70.13	94.76	—
1 sq. x 7"	76.13	—	112.56	103.95	140.71	—

SIZE	M2 R/C 64.5-66	M3* R/C 65-66.5	M42 R/C 67-69	M34* R/C 65-67	T15PM R/C 65-67
1/4" x 3/8" x 2-1/2"	7.36	—	—	—	—
x 3/8" x 3"	8.87	—	11.01	—	12.27
x 1/2" x 3"	9.48	—	—	—	—
x 1/2" x 4"	11.73	—	14.37	—	17.19
x 1/2" x 6"	18.87	—	20.27	—	23.21
x 3/4" x 5"	17.04	17.90	21.67	—	26.20
x 1" x 6"	26.98	28.40	34.46	—	41.75
5/16" x 7/16" x 3"	10.11	—	—	—	—
x 7/16" x 3-1/2"	11.78	—	14.25	—	16.94
x 1/2" x 3"	11.52	—	—	13.74	—
x 5/8" x 4"	15.51	—	19.41	—	23.30
3/8" x 1/2" x 3"	11.18	—	—	—	—
x 1/2" x 4"	14.97	15.62	18.72	—	22.63
x 1/2" x 6"	22.35	—	—	27.66	—
x 5/8" x 4"	16.28	—	—	—	—
x 5/8" x 4-1/2"	18.31	—	23.49	—	28.60
x 5/8" x 5"	—	—	—	—	—
x 5/8" x 6"	24.44	—	—	—	—
x 3/4" x 4"	18.39	—	—	—	—
x 3/4" x 5"	23.00	—	29.68	—	36.24
x 3/4" x 6"	27.57	—	—	—	—
x 1" x 6"	34.09	—	45.12	—	55.15
1/2" x 5/8" x 4-1/2"	20.36	—	27.35	—	33.46
x 3/4" x 4"	22.93	—	—	—	—
x 3/4" x 5"	25.64	—	33.96	—	42.70
x 3/4" x 6"	30.77	—	—	—	—
x 1" x 7"	52.23	57.70	67.74	—	84.50
x 1" x 8"	59.63	—	—	—	—
5/8" x 3/4" x 5"	34.38	—	45.82	—	55.91
x 7/8" x 6"	47.83	—	64.11	—	78.10
x 1" x 7"	63.73	—	84.54	—	103.36
x 1-1/4" x 7"	79.60	—	105.57	—	128.93
x 1-1/2" x 7"	93.06	—	123.78	—	151.73

*** AVAILABLE UNTIL
STOCK IS EXHAUSTED**

**Flat Form - Ground
High Speed Tool Bits**
Tolerance on Width and
Thickness ±.002
Square Ends

**Additional Sizes and Materials
Available — Call for Price
and Delivery**

**All Toolbits can be custom
ground to meet your
requirements**

WILLIAM T. HUTCHINSON CO.

TOLL FREE 1-800-544-7934 • (908) 688-0533 • FAX (908) 688-8296 • ESTABLISHED 1927

www.hssblanks.com

SQUARE & FLAT FORM TOOL BITS

SIZE	M2	M3*	M42	T15
	R/C 64.5-66	R/C 65-66.5	R/C 67-69	R/C 65-67
3/4" x 1" x 6" x 1" x 7" x 1-1/4" x 7" x 1-1/2" x 7"	63.46	—	—	—
	74.07	79.10	99.19	121.58
	93.06	—	123.69	151.78
	103.63	—	140.20	172.56
7/8" x 1-1/8" x 7" x 1-1/4" x 7"	98.01	—	—	—
	108.92	—	146.41	177.12
1" x 1-1/4" x 6"	98.73	—	133.83	165.03

**Flat Form - Ground
High Speed Tool Bits**
Tolerance on Width and
Thickness $\pm .002$
Square Ends

* AVAILABLE UNTIL
STOCK IS EXHAUSTED

**Thin Flat Form - Ground
High Speed Tool Bits**
Tolerance on Width and
Thickness $+.002$
-.000
Square Ends

**T15 & T15PM
Long High Speed Tool Bits**
R/C 65-67

SIZE	T15PM
3/16 x sq. x 6"	17.45
1/4 x sq. x 6"	19.30
1/4 x sq. x 8"	25.73
5/16 x sq. x 6"	22.67
3/8 x sq. x 6"	25.91
3/8 x sq. x 8"	34.55
7/16 x sq. x 6"	29.27
1/2 x sq. x 6"	36.07
1/2 x sq. x 8"	48.09
5/8 x sq. x 6"	50.04
5/8 x sq. x 8"	66.74

**Tolerance on Width
and Thickness $\pm .002$**
Ends Beveled 10°

SIZE	M2	M42	T15PM
	R/C 62-64	R/C 66-68	R/C 65-67
1/16" x 1/2" x 6" x 5/8" x 6" x 3/4" x 6" x 7/8" x 6" x 1" x 6"	10.13	14.61	12.09
	10.87	12.41	13.41
	12.37	16.36	15.20
	13.26	15.37	16.53
	13.99	18.39	17.69
3/32" x 1/2" x 6" x 5/8" x 6" x 3/4" x 6" x 7/8" x 6" x 1" x 6"	11.14	13.97	18.50
	12.03	14.01	15.19
	13.36	15.79	21.64
	14.43	17.20	18.71
	15.70	18.84	25.43
1/8" x 1/2" x 6" x 5/8" x 6" x 3/4" x 6" x 7/8" x 6" x 1" x 6"	13.44	20.50	18.64
	13.04	15.43	16.73
	14.94	23.43	22.43
	15.67	18.91	20.71
	17.68	28.17	26.36
5/32" x 1/2" x 6" x 5/8" x 6" x 3/4" x 6" x 7/8" x 6" x 1" x 6"	15.43	19.57	20.64
	14.86	17.96	19.66
	17.50	22.50	24.43
	17.94	22.16	24.49
	20.79	28.03	29.71
3/16" x 1/2" x 6" x 5/8" x 6" x 3/4" x 6" x 7/8" x 6" x 1" x 6"	14.54	18.00	20.29
	15.94	19.44	21.39
	17.77	21.91	24.07
	19.34	24.11	26.76
	21.14	26.56	29.54
1/4" x 1/2" x 6" x 5/8" x 6" x 3/4" x 6" x 7/8" x 6" x 1" x 6"	18.87	20.27	23.21
	18.44	22.73	25.10
	22.13	25.63	29.86
	22.41	28.24	31.47
	26.98	34.46	41.75

**Typical Analysis of High Speed Steel
Tool Bit Materials**

	C	Cr	Mo	W	V	Co
M2	.85	4.15	5.00	6.30	1.85	—
M3	1.20	4.10	5.00	6.00	3.00	—
M42	1.10	3.75	9.50	1.50	1.15	8.25
T15 & T15PM	1.57	4.00	—	12.25	5.00	5.00
M34	.90	3.75	8.00	1.50	2.05	8.25

WILLIAM T. HUTCHINSON CO.

TOLL FREE 1-800-544-7934 • 453 LEHIGH AVENUE • UNION, NEW JERSEY 07083-7928

CARBIDE BLANKS STYLE 1000 & 2000

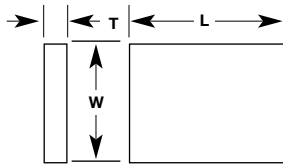

Style 1000

C-2 GRADE
PREMIUM MEDIUM
GRAIN CARBIDE
WITH 6-8% COBALT

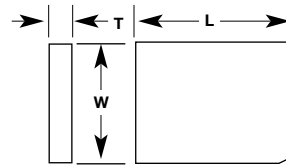

Style 2000

Dimensions				Blank Number	Price	Blank Number	Price
T	W	L	R	STYLE 1000	1 - 249 pcs.	STYLE 2000	1 - 249 pcs.
1/16	1/8	5/8	1/8	1010	.68	2010	.68
1/16	3/16	1/4	1/8	1020	.67	2020	.67
1/16	1/4	5/16	1/8	1030	.68	2030	.68
3/32	3/16	5/16	1/8	1040	.70	2040	.70
3/32	3/16	1/2	1/8	1050	.96	2050	.96
3/32	1/4	3/8	1/8	1060	.89	2060	.89
3/32	1/4	1/2	1/8	1070	1.04	2070	1.04
3/32	5/16	3/8	3/16	1080	.98	2080	.92
3/32	3/8	3/8	3/16	1090	1.09	2090	.98
3/32	3/8	1/2	3/16	1100	1.20	2100	1.25
3/32	7/16	1/2	1/4	1105	1.43	2105	1.43
1/8	3/16	3/4	1/8	1110	1.25	2110	1.20
1/8	1/4	1/2	1/8	1120	.97	2120	1.06
1/8	1/4	5/8	1/8	1130	1.22	2130	1.34
1/8	1/4	3/4	1/8	1140	1.62	2140	1.62
1/8	5/16	7/16	3/16	1150	1.16	2150	1.22
1/8	5/16	1/2	3/16	1160	1.22	2160	1.24
1/8	5/16	5/8	3/16	1170	1.51	2170	1.51
1/8	3/8	1/2	3/16	1180	1.47	2180	1.47
1/8	3/8	3/4	3/16	1190	2.18	2190	2.14
1/8	1/2	1/2	1/4	1200	1.93	2200	1.93
1/8	1/2	3/4	1/4	1210	2.90	2210	2.90
1/8	3/4	3/4	1/4	1215	4.33	2215	4.29
5/32	3/8	9/16	3/16	1220	2.11	2220	2.11
5/32	3/8	3/4	3/16	1230	2.69	2230	2.69
5/32	5/8	5/8	1/4	1240	3.74	2240	3.70
3/16	5/16	7/16	3/16	1250	1.55	2250	1.55
3/16	5/16	5/8	3/16	1260	2.23	2260	2.23
3/16	3/8	1/2	3/16	1270	2.14	2270	2.14
3/16	3/8	5/8	3/16	1280	2.69	2280	2.65
3/16	3/8	3/4	3/16	1290	3.19	2290	3.19
3/16	7/16	5/8	1/4	1300	3.11	2300	3.07
3/16	7/16	13/16	1/4	1310	3.99	2310	4.03
3/16	1/2	1/2	1/4	1320	2.86	2320	2.86
3/16	1/2	3/4	1/4	1330	4.24	2330	4.24
3/16	3/4	3/4	1/4	1340	6.11	2340	6.30

ALL STYLE 1000, 2000, STB & STBL SERIES
BLANKS LISTED ARE **UNGROUND**

THICKNESS: MINIMUM GRIND STOCK
1/16" TO 5/16" +0.04" - +0.015" ON ALL DIMENSIONS
3/8" TO 1" +0.06" - +0.020" ON ALL DIMENSIONS

GROUND BLANKS TO YOUR SPECIFICATIONS
ARE AVAILABLE • PRICES UPON REQUEST

C-5 GRADE PREMIUM MEDIUM GRAIN
CARBIDE WITH 10% COBALT ALSO AVAILABLE

WILLIAM T. HUTCHINSON CO.

TOLL FREE 1-800-544-7934 • (908) 688-0533 • FAX (908) 688-8296 • ESTABLISHED 1927

CARBIDE BLANKS STYLE STB - STBL

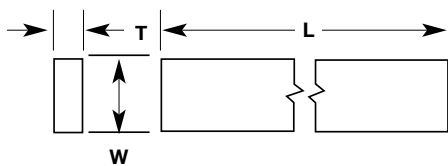

Style STB-STBL

Dimensions			Blank Number	Price ea.
T	W	L		
1/32	1/16	1	STB-12	.89
1/32	1/16	1-1/2	STB-12A	1.18
3/64	3/32	13/16	STB-13A	1.10
3/64	3/32	1	STB-13	1.22
1/16	1/16	6	STB-22L	6.09
1/16	1/8	1	STB-24A	1.17
1/16	1/8	1-1/4	STB-24C	1.44
1/16	1/8	1-1/2	STB-24D	1.51
1/16	1/8	3	STB-24B	2.65
1/16	1/8	6	STB-24L	6.53
1/16	3/16	1	STB-26A	1.32
1/16	3/16	3	STB-26C	3.87
1/16	3/16	6	STB-26L	9.47
1/16	1/4	1	STB-28A	1.75
1/16	1/4	1-1/4	STB-28B	2.17
1/16	1/4	3	STB-28D	5.03
1/16	1/4	6	STB-28L	9.22
1/16	5/16	6	STB-210L	17.87
1/16	3/8	6	STB-212L	20.26
1/16	1/2	6	STB-216L	23.69
1/16	5/8	6	STB-220L	33.61
1/16	3/4	6	STB-224L	37.81
1/16	1	6	STB-232L	43.34
5/64	1/8	1-1/8	STB-14	1.46
3/32	1/8	5	STB-34	6.99
3/32	1/8	8	STB-34L	9.06
3/32	3/16	1-1/8	STB-36	1.91
3/32	3/16	1-1/4	STB-36A	2.12
3/32	3/16	8	STB-36L	10.76
3/32	1/4	1	STB-38A	2.22
3/32	1/4	1-1/2	STB-38B	3.28
3/32	1/4	5	STB-38D	10.49
3/32	1/4	8	STB-38L	12.21
3/32	5/16	2	STB-310A	5.35
3/32	5/16	3	STB-310B	5.69
3/32	5/16	5	STB-310C	9.38
3/32	5/16	8	STB-310L	15.26
3/32	3/8	5	STB-312	12.93
3/32	3/8	8	STB-312L	17.90
3/32	1/2	8	STB-316L	23.59
3/32	5/8	8	STB-320L	29.32
1/8	1/8	12	STB-44L	12.48

Dimensions			Blank Number	Price ea.
T	W	L		
1/8	3/16	6	STB-46	10.15
1/8	3/16	12	STB-46L	22.78
1/8	1/4	1	STB-48A	2.86
1/8	1/4	1-1/4	STB-48B	3.55
1/8	1/4	1-1/2	STB-48F	4.24
1/8	1/4	2-1/4	STB-48C	6.30
1/8	1/4	3	STB-48D	5.92
1/8	1/4	6	STB-48E	11.76
1/8	1/4	12	STB-48L	23.56
1/8	5/16	1-1/2	STB-410A	5.24
1/8	5/16	3	STB-410B	7.31
1/8	5/16	6	STB-410	14.55
1/8	3/8	1	STB-412D	4.24
1/8	3/8	2	STB-412A	5.84
1/8	3/8	3	STB-412B	8.71
1/8	3/8	6	STB-412C	17.30
1/8	3/8	12	STB-412L	34.64
1/8	1/2	1	STB-416A	5.56
1/8	1/2	1-1/2	STB-416B	5.84
1/8	1/2	3	STB-416C	11.49
1/8	1/2	6	STB-416	22.84
1/8	1/2	12	STB-416L	45.68
1/8	5/8	6	STB-420	28.38
1/8	5/8	12	STB-420L	56.76
1/8	3/4	6	STB-424	33.92
1/8	3/4	12	STB-424L	67.84
1/8	1	6	STB-432	45.34
1/8	1	12	STB-432L	90.68
3/16	3/16	12	STB-66L	24.57
3/16	1/4	3	STB-68A	8.59
3/16	1/4	6	STB-68	17.07
3/16	1/4	12	STB-68L	34.15
3/16	5/16	3	STB-610A	12.28
3/16	5/16	6	STB-610	21.07
3/16	5/16	12	STB-610L	42.17
3/16	3/8	3	STB-612A	12.63
3/16	3/8	6	STB-612	25.10
3/16	3/8	12	STB-612L	50.20
3/16	1/2	3	STB-616A	16.66
3/16	1/2	6	STB-616	33.13
3/16	1/2	12	STB-616L	66.22
3/16	5/8	3	STB-620A	20.69

C2 MEDIUM
GRAIN CARBIDE
6-8% COBALT

OTHER GRADES
AVAILABLE UPON
REQUEST

MINIMUM GRIND
STOCK TOLERANCES

THICKNESS +0.008"
WIDTH +0.012"
LENGTH +0.008"

PARALLEL AND FLAT
WITHIN 0.020"

ADDITIONAL
QUANTITY
DISCOUNTS
AVAILABLE

SEE PAGE 15
FOR
CARBIDE
DRILL BLANKS

WILLIAM T. HUTCHINSON CO.

TOLL FREE 1-800-544-7934 • 453 LEHIGH AVENUE • UNION, NEW JERSEY 07083-7928

www.hssblanks.com

INDEXABLE INSERTS & DOVETAIL TOOL BLANKS

Triangular High Speed Steel T15 Inserts

Style Number	ANSI Standard	DIMENSIONS			PRICE PER PIECE
		S	T	R	
30074	TPG-322	.375	.125	.031	11.30
30085	TPG-433	.500	.188	.047	13.74
30096	TPG-544	.625	.250	.062	21.13

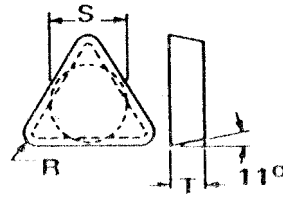

Square High Speed Steel T15 Inserts

Style Number	ANSI Standard	DIMENSIONS			PRICE PER PIECE
		S	T	R	
30110	SPG-322	.375	.125	.031	10.02
30121	SPG-422	.500	.125	.031	11.84
30132	SPG-633	.750	.188	.047	17.75

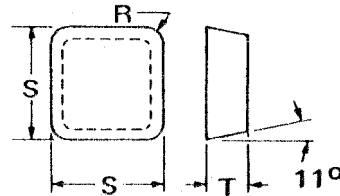

All sizes fit standard positive rake holders same as used for carbide inserts. Other radii available on application. Standard package quantity 10 pieces.

Dovetail Form Tool Blanks (M42)

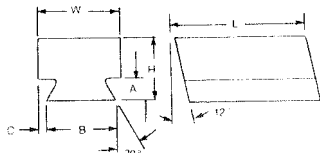

Dovetail Form Tool Holder	H	W	L	A	B	C	Style	Price Per Piece	Style Number
	+0.015 -0.000	+0.015 -0.000	±0.030	+0.015 -0.000	±0.003	±0.005			
3/8	3/4	1	1-1/2	19/64	.700	1/4	3/8-DF-1	41.57	35588
5/8	1	1	2-1/4	19/64	.951	1/16	5/8-DF-1	63.84	35599
5/8	1	1-1/2	2-1/4	19/64	.951	9/16	5/8-DF-2	83.93	35602
5/8	1	2	2-1/4	19/64	.951	17/32	5/8-DF-3	104.39	35613
1	1-1/2	2	3	35/64	1.614	3/16	1-DF-1	176.22	35624
1	1-1/2	2-1/2	3	35/64	1.614	7/16	1-DF-2	211.66	35635
1	1-1/2	3	3	35/64	1.614	11/16	1-DF-3	248.34	35646
1-1/4	1-1/2	2	3	35/64	1.882	1/8	1-1/4-DF-1	180.34	35657
1-1/4	1-1/2	2-1/2	3	35/64	1.882	9/16	1-1/4-DF-2	215.76	35668
1-1/4	1-1/2	3	3	35/64	1.882	9/16	1-1/4-DF-3	250.60	35679
1-5/8	1-1/2	3	3	35/64	2.238	3/8	1-5/8DF-1	255.56	35690
2-1/8	1-1/2	3	3	43/64	2.883	1/8	2-1/8DF-1	259.00	35704

Dovetail Shave Tool Blanks (M42)

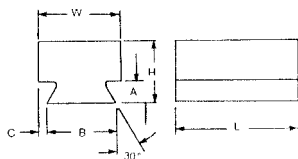

Dovetail Shave Tool Holder	H	W	L	A	B	C	Style	Price Per Piece	Style Number
	+0.015 -0.000	+0.015 -0.000	±0.030	+0.015 -0.000	±0.003	±0.005			
1/2	5/8	1-1/4	1-1/8	13/64	.714	3/8	1/2-DS-1	34.68	35715
5/8	3/4	1	1-1/2	17/64	.912	3/32	5/8-DS-1	40.52	35726
5/8	3/4	1-1/2	1-1/2	17/64	.912	19/64	5/8-DS-2	52.89	35737
5/8	3/4	2	1-1/2	17/64	.912	35/64	5/8-DS-3	64.76	35748
1	1	1-1/2	1-3/4	17/64	1.287	7/32	1-DS-1	67.94	35759
1	1	2	1-3/4	17/64	1.287	23/64	1-DS-2	83.99	35770
1-1/4	1	2	1-3/4	17/64	1.554	11/32	1-1/4-DS-1	88.11	35781
1-1/2	1	2	1-7/8	17/64	1.787	7/32	1-1/2-DS-1	92.81	35792
1-5/8	1-1/2	2-1/2	2-9/16	25/64	2.057	11/32	1-5/8DS-1	180.49	35806

WILLIAM T. HUTCHINSON CO.

TOLL FREE 1-800-544-7934 • (908) 688-0533 • FAX (908) 688-8296 • ESTABLISHED 1927

CUTOFF WHEELS & SAFETY FLANGES

DIAMETER	WIDTH	BORE	PRICE
7"	1/32 1/16	1-1/4	CALL FOR PRICING
8"	1/32 1/16	1-1/4	

Hutchinson tool room cut off wheels are designed by toolmakers for toolmakers. These wheels are formulated for tool room applications where precise cutting is required.



REINFORCED CUTOFF WHEELS

DIAMETER	WIDTH	BORE	PRICE
10"	1/16	5/8	CALL FOR PRICING
12"	1/32	1-1/4 1" (w/bushing)	

Free cutting, long lasting, designed for applications where the workpiece is hand clamped or side pressure is evident. Center reinforced for reduced drag.

— TRU-GRIP — TOOLMAKERS SAFETY FLANGES

CONFORMS TO ANSI SAFETY CODE 5-1-1

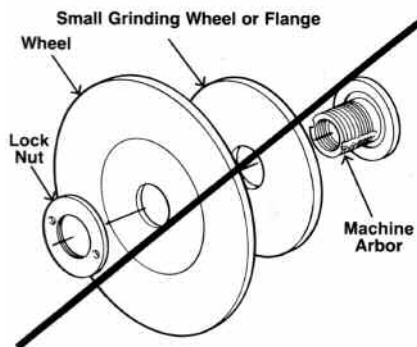

INCORRECT TO ANSI SAFETY CODE 5-1-1

USES

- Mounting of thin Cut Off Wheels
- Mounting of thin Diamond Wheels
- Mounting of thin Grinding Wheels
- Mounting of thin Borazon Wheels
- Uniform Location
- For use with 6", 7", 8", 10" Diameter Wheels

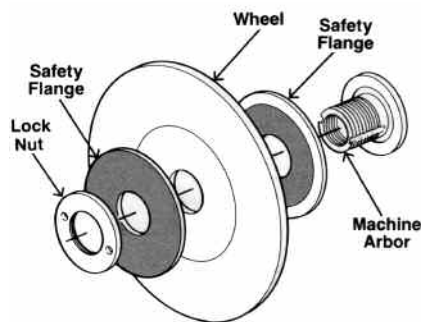

— TRU-GRIP —

CORRECT TO ANSI SAFETY CODE 5-1-1

FEATURES

- Protective Balance
- Positive Clamping
- Reduces Wheel Distortion
- Recessed to Safety Code
- Reinforced Composite Material for Strength and Safety
- Standard 1 1/4" Arbor Hole

Only \$17.50 / pair

WILLIAM T. HUTCHINSON CO.

TOLL FREE 1-800-544-7934 • 453 LEHIGH AVENUE • UNION, NEW JERSEY 07083-7928

www.hssblanks.com

DIAMOND WHEELS AND TOOLS

TYPE 11V9 FLARING CUP DIAMOND WHEELS

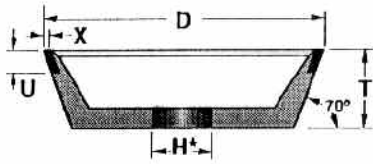

100% CONCENTRATION

D IN.	T IN.	U IN.	X IN.	PRICE EACH
3 3/4	1 1/2	3/8	1/16	99.00
			1/8	115.00
5	1 1/4	7/16	1/16	130.00
			1/8	150.00

AVAILABLE IN GRIT SIZES
 320-(FINE)
 150-(MEDIUM)
 100-(COARSE)
 Specify (H) hole size

TYPE 1A1 STRAIGHT STYLE 6" DIAMOND WHEELS

T IN.	X IN.	PRICE EACH
1/8	1/8	114.00
1/4	1/16	128.00
1/4	1/8	138.00
3/8	1/8	169.00
1/2	1/8	190.00

AVAILABLE IN GRIT SIZES
 320-(FINE)
 150-(MEDIUM)
 100-(COARSE)
 100% CONCENTRATION
 Specify (H) hole size

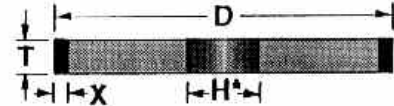

TYPE 6A2C CUP STYLE DIAMOND WHEELS WITH COUNTERSUNK BOLT HOLES

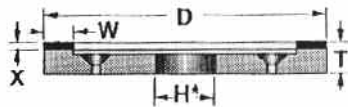

D IN.	T IN.	W IN.	X IN.	PRICE EACH
6	3/4	3/4	1/16	149.00
			1/8	199.00

75% CONCENTRATION
 AVAILABLE IN GRIT SIZES
 320-(FINE)
 150-(MEDIUM)
 100-(COARSE)
 Specify (H) hole size

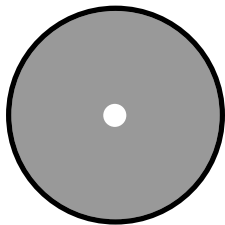

6" DIAMOND CUT-OFF WHEEL

.035 Thickness
 1 1/4" Hole
 1/4" Diamond Depth
 100% Concentration
 GRIT D100
 85.00 Each

DIAMOND CLEANING STICK



Aluminum Oxide
 150 Grit
 1 x 1 x 6
 6.79 Each

JIG GRINDING MANDRELS

(D) Diameter	(H) Length	(L) Neck	Price Each	(D) Diameter	(H) Length	Price Each
.156	.250	.500	21.75	.390	.375	36.00
.187	.250	.500	22.40	.406	.375	36.65
.203	.250	.500	22.40	.437	.375	39.35
.218	.250	.500	23.10	.500	.375	46.15
.236	.250	.500	23.75	.562	.375	48.20
.250	.250	.500	24.45	.625	.375	50.20
.281	.250	—	25.80	.750	.375	61.75
.312	.375	—	28.50	.875	.375	71.25
.375	.375	—	32.60	1.000	.375	88.90

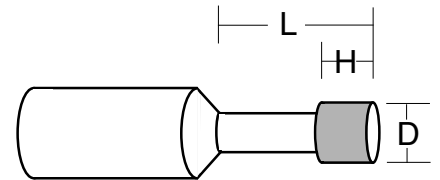

+ .0
 - .001
 1/4" Shank
 100 Grit
 3" Overall Length

Also Available:
 1/8" or 3/8" Shank
 Diameters to .016

WILLIAM T. HUTCHINSON CO.

TOLL FREE 1-800-544-7934 • (908) 688-0533 • FAX (908) 688-8296 • ESTABLISHED 1927

DIAMOND TOOLS



Diamond Plated Needle Nose Files

3" Diamond length
5½" Overall length
1/8" shank

Available in grit sizes:

200 FINE
150 MEDIUM
100 COARSE

\$14.90 each

Tool No.	Style	Cross Section	Size (inches)
NN-1	Oval		.150 x .105
NN-2	Half-round		.218 x .072
NN-3	Equaling		.205 x .508
NN-4	Square		.096 x .096
NN-5	Three Square		.138 x .138
NN-6	Round		.118
NN-7	Crossing		.197 x .088
NN-8	Barretts		.205 x .067

Diamond Plated Bore Laps

Diameter	Length of Diamond	Price Each
3/16	1/2	37.50
7/32	1/2	40.00
1/4	1/2	46.25
9/32	1/2	48.75
5/16	1/2	53.75
11/32	1/2	58.75
3/8	3/4	63.75
13/32	3/4	70.00
7/16	3/4	72.50
15/32	3/4	76.25
1/2	1	91.25
9/16	1	98.75
5/8	1	107.50
11/16	1	118.75
3/4	1	138.75
7/8	1	162.50
1	1	181.25



STANDARD GRIT 220
OTHER GRITS AVAILABLE

SCREW ADJUSTMENT EXPANDS
DIAMETER

CBN PLATED ALSO AVAILABLE
SPECIFY BARREL OR BLIND HOLE
LAP WHEN ORDERING
NEEDLE EYE LAPS AVAILABLE TO
.030 DIA - CALL FOR PRICING

SINGLE END DIAMOND HAND HONE



L IN.	W IN.	T IN.	L1 IN.	X IN.	PRICE EACH
4	1/4	1/4	1¼	1/8	37.50
6	3/8	3/8	1¼	1/8	46.25

DOUBLE END DIAMOND HAND HONE



L IN.	W IN.	T IN.	L1 IN.	X IN.	PRICE EACH
4	1/4	1/4	1¼	1/8	60.00
6	3/8	3/8	1¼	1/8	73.75

AVAILABLE IN
GRIT SIZES
600-(FINE)
320-(MEDIUM)
150-(COURSE)

WILLIAM T. HUTCHINSON CO.

TOLL FREE 1-800-544-7934 • 453 LEHIGH AVENUE • UNION, NEW JERSEY 07083-7928

DOWEL PINS

Length	Diameter					
	1/16	3/32	1/8	3/16	1/4	5/16
3/16	*	*	*	—	—	—
1/4	*	*	*	*	*	—
5/16	*	*	*	*	*	—
3/8	*	*	*	*	*	*
7/16	*	*	*	*	*	—
1/2	*	*	*	*	*	*
5/8	*	*	*	*	*	*
3/4	*	*	*	*	*	*
7/8	*	*	*	*	*	*
1	*	*	*	*	*	*
1 1/8	—	—	*	*	*	*
1 1/4	*	*	*	*	*	*
1 3/8	—	—	*	*	*	*
1 1/2	—	*	*	*	*	*
1 5/8	—	—	*	—	*	—
1 3/4	—	*	*	*	*	*
2	—	—	*	*	*	*
2 1/4	—	—	*	*	*	*
2 1/2	—	—	*	*	*	*
2 3/4	—	—	*	*	*	*
3	—	—	*	*	*	*
3 1/4	—	—	—	—	*	*
3 1/2	—	—	—	—	*	*
3 3/4	—	—	—	—	*	*
4	—	—	—	—	*	*

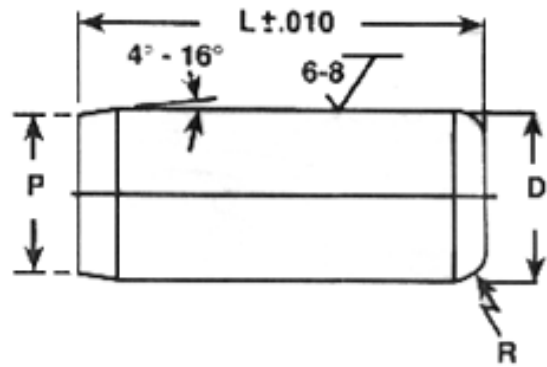

Nom Size	D				P		R	
	STANDARD		.001 Oversized		Point Diameter		Crown height or Radius	
	Max.	Min.	Max.	Min.	Max.	Min.	Max.	Min.
1/16	.0628	.0626	.0636	.0634	0.058	0.048	0.020	0.008
3/32	.0941	.0939	.0949	.0947	0.089	0.079	0.031	0.012
1/8	.1253	.1251	.1261	.1259	0.120	1.110	0.041	0.016
3/16	.1878	.1876	.1886	.1884	0.180	0.179	0.062	0.023
1/4	.2503	.2501	.2511	.2509	0.240	0.230	0.083	0.031
5/16	.3128	.3126	.3136	.3134	0.302	0.290	0.104	0.039
3/8	.3753	.3751	.3761	.3759	0.365	0.350	0.125	0.047
7/16	.4378	.4376	.4386	.4384	0.424	0.409	0.146	0.055
1/2	.5003	.5001	.5011	.5009	0.486	0.471	0.167	0.063
5/8	.6253	.6251	.6261	.6259	0.611	0.595	0.208	0.078
3/4	.7503	.7501	.7511	.7509	0.735	0.715	0.250	0.094
7/8	.8753	.8751	.8761	.8759	0.860	0.840	0.293	0.109
1	1.0003	1.0001	1.0011	1.0009	0.980	0.960	0.333	0.125

Length	Diameter							
	3/8	7/16	1/2	9/16	5/8	3/4	7/8	1"
1/2	*	*	*	—	—	—	—	—
5/8	*	—	*	—	—	—	—	—
3/4	*	*	*	—	*	*	—	—
7/8	*	*	*	—	—	—	—	—
1	*	*	*	*	*	*	*	*
1 1/8	*	—	*	—	—	—	—	*
1 1/4	*	*	*	*	*	*	—	*
1 3/8	*	—	—	—	—	*	—	*
1 1/2	*	*	*	*	*	*	*	*
1 5/8	—	*	*	—	—	*	—	—
1 3/4	*	*	*	*	*	*	*	*
2	*	*	*	*	*	*	*	*
2 1/4	*	*	*	*	*	*	*	*
2 1/2	*	*	*	*	*	*	*	*
2 3/4	*	*	*	*	*	*	*	*
3	*	*	*	*	*	*	*	*
3 1/4	*	*	*	—	*	*	*	*
3 1/2	*	*	*	*	*	*	*	*
3 3/4	*	—	*	—	*	—	—	—
4	*	*	*	*	*	*	*	*
4 1/2	—	—	*	*	*	*	*	*
5	—	—	*	*	*	*	*	*
5 1/2	—	—	*	—	—	—	—	—
6	—	—	*	—	*	*	*	*

- All pins are heat treated to Rockwell 60-64C
- .001 oversized \pm .0001
Prices on application
- Made in USA
- Dowel pins can be custom ground to special diameters to meet your requirements

NO MINIMUM ORDER

***Call for current pricing**

WILLIAM T. HUTCHINSON CO.

TOLL FREE 1-800-544-7934 • (908) 688-0533 • FAX (908) 688-8296 • ESTABLISHED 1927

DOWEL PINS

303 STAINLESS DOWEL PINS

Length	1/8	3/16	1/4	5/16	3/8	1/2	5/8
1/2	*	*	*	*	*	—	—
5/8	*	*	*	*	*	*	—
3/4	*	*	*	*	*	*	—
7/8	*	*	*	*	*	—	—
1	*	*	*	*	*	*	*
1 1/4	*	*	*	*	*	*	*
1 1/2	*	*	*	*	*	*	*
1 3/4	*	*	*	*	*	*	*
2	*	*	*	*	*	*	*
2 1/2	*	*	*	*	*	*	*
3	*	*	*	*	*	*	*
3 1/2	*	—	*	*	*	*	*
4	*	—	*	*	*	*	*

METRIC DOWEL PINS

Length in MM	4	5	6	8	10	12	16	20	Length in MM
12	*	*	*	*	—	—	—	—	12
14	*	*	—	—	—	—	—	—	14
16	*	*	*	*	*	—	—	—	16
18	*	*	—	—	*	—	—	—	18
20	*	*	*	*	*	*	*	—	20
25	*	*	*	*	*	*	*	*	25
30	*	*	*	*	*	*	*	*	30
35	*	*	*	*	*	*	*	—	35
40	*	*	*	*	*	*	*	*	40
45	—	—	*	*	*	*	*	—	45
50	*	*	*	*	*	*	*	*	50
55	*	*	*	*	*	*	—	—	55
60	*	*	*	*	*	*	*	*	60
65	—	*	*	*	*	*	—	—	65
70	*	*	—	*	*	*	*	*	70
80	—	—	*	*	*	*	—	*	80
90	—	—	*	*	*	*	*	—	90
100	—	—	*	—	*	*	—	*	100

METRIC PULL DOWEL PINS

Length in MM	6	8	10	12	16	20	Length in MM
20	*	*	*	*	—	—	20
25	*	*	*	*	*	—	25
30	*	*	*	*	*	*	30
35	*	*	*	*	*	*	35
40	*	*	*	*	*	*	40
45	*	*	*	*	*	*	45
50	*	*	*	*	*	*	50
55	*	*	*	*	*	*	55
60	*	*	*	*	*	*	60
70	*	*	*	*	*	*	70
75	—	—	*	*	*	*	75
80	*	*	*	*	*	*	80
100	—	—	*	*	*	*	100

NO MINIMUM ORDER

***CALL FOR CURRENT PRICING**

WILLIAM T. HUTCHINSON CO.

TOLL FREE 1-800-544-7934 • 453 LEHIGH AVENUE • UNION, NEW JERSEY 07083-7928

SOCKET HEAD CAP & SET SCREWS

BUTTON HEAD SOCKET CAP SCREWS

Length	4/40	6/32	8/32	10/24	10/32	1/4-20	5/16-18	3/8-16
1/4	*	*	*	*	*	—	—	—
3/8	*	*	*	*	*	*	—	—
1/2	*	*	*	*	*	*	*	*
5/8	—	*	*	*	*	*	*	*
3/4	—	—	*	*	*	*	*	*
1	—	—	—	*	*	*	*	*
1 1/4	—	—	—	—	—	—	—	*

METRIC SOCKET HEAD CAP SCREWS

Length	M8	M10
16	*	—
20	*	*
25	*	*
30	*	*
35	*	*
40	*	*
45	*	*
50	*	*
55	*	*
60	*	*
65	*	*
70	*	*
75	*	*

*Call for current pricing

FLAT HEAD SOCKET CAP SCREWS

Length	4/40	5/40	6/32	8/32	10/24	10/32	1/4-20	5/16-18	3/8-16	1/2-13	5/8-11	3/4-10
1/4	*	*	*	—	—	—	—	—	—	—	—	—
3/8	*	*	*	*	*	*	*	—	—	—	—	—
1/2	*	*	*	*	*	*	*	*	—	—	—	—
5/8	*	*	*	*	*	*	*	*	—	—	—	—
3/4	*	*	*	*	*	*	*	*	*	*	—	—
1	—	—	—	*	*	*	*	*	*	*	—	—
1 1/4	—	—	—	—	*	*	*	*	*	*	*	—
1 1/2	—	—	—	—	*	*	*	*	*	*	*	*
1 3/4	—	—	—	—	—	—	*	*	*	*	*	*
2	—	—	—	—	—	—	*	*	*	*	*	*
2 1/4	—	—	—	—	—	—	—	—	—	*	*	*
2 1/2	—	—	—	—	—	—	—	—	—	*	*	*
3	—	—	—	—	—	—	—	—	—	*	*	*

SOCKET SET SCREWS – CUP POINT (OTHER POINTS AND DIAMETERS AVAILABLE PRICES ON APPLICATION)

Length	0/80	1/72	2/56	3/48	4/40	5/40	6/32	8/32	10/24	10/32
1/16	—	*	*	—	—	—	—	—	—	—
3/32	*	*	*	*	—	—	—	—	—	—
1/8	*	*	*	*	*	*	*	*	—	—
3/16	*	*	*	*	*	*	*	*	*	*
1/4	*	*	*	*	*	*	*	*	*	*
5/16	—	—	—	—	*	*	*	*	*	*
3/8	—	—	—	—	*	*	*	*	*	*
1/2	—	—	—	—	*	*	*	*	*	*
5/8	—	—	—	—	—	—	—	—	*	*
3/4	—	—	—	—	—	—	—	—	*	*
1	—	—	—	—	—	—	—	—	—	*
1 1/4	—	—	—	—	—	—	—	—	—	*

Length	1/4-20	1/4-28	5/16-18	5/16-24	3/8-16	3/8-24	1/2-13
3/16	*	*	—	—	—	—	—
1/4	*	*	*	*	*	*	—
5/16	*	*	*	*	*	*	—
3/8	*	*	*	*	*	*	—
1/2	*	*	*	*	*	*	*
5/8	*	—	*	*	*	*	*
3/4	*	—	*	*	*	*	*
1	*	—	*	*	*	*	*
1 1/4	*	—	*	—	*	*	*
1 1/2	*	—	*	—	*	*	*

WILLIAM T. HUTCHINSON CO.

TOLL FREE 1-800-544-7934 • (908) 688-0533 • FAX (908) 688-8296 • ESTABLISHED 1927

SOCKET HEAD CAP SCREWS

Length	0/80	1/72	2/56	3/48	4/40	5/40	6/32	6/40	8/32	8/36	10/24	10/32	1/4-20	1/4-28
1/8	*	*	—	—	—	—	—	—	—	—	—	—	—	—
3/16	*	*	*	*	—	—	—	—	—	—	—	—	—	—
1/4	*	*	*	*	*	*	*	—	*	—	—	—	—	—
3/8	*	*	*	*	*	*	*	*	*	*	*	*	*	*
1/2	—	—	*	*	*	*	*	*	*	*	*	*	*	*
5/8	—	—	—	—	*	*	*	*	*	—	*	*	*	*
3/4	—	—	—	—	*	*	*	*	*	*	*	*	*	*
7/8	—	—	—	—	—	—	*	—	*	—	*	*	*	—
1	—	—	—	—	—	—	*	—	*	—	*	*	*	*
1 1/4	—	—	—	—	—	—	—	—	*	—	*	*	*	*
1 1/2	—	—	—	—	—	—	—	—	*	—	*	*	*	*
1 3/4	—	—	—	—	—	—	—	—	—	—	*	*	*	*
2	—	—	—	—	—	—	—	—	—	—	*	*	*	*
2 1/4	—	—	—	—	—	—	—	—	—	—	—	—	*	—
2 1/2	—	—	—	—	—	—	—	—	—	—	—	—	*	—
2 3/4	—	—	—	—	—	—	—	—	—	—	—	—	*	—
3	—	—	—	—	—	—	—	—	—	—	—	—	*	—

Length	5/16-18	5/16-24	3/8-16	3/8-24	7/16-14	1/2-13	1/2-20	5/8-11	3/4-10	1-8
1/2	*	—	*	—	—	*	—	—	—	—
5/8	*	*	*	—	—	—	—	—	—	—
3/4	*	*	*	*	*	*	—	—	—	—
7/8	*	*	*	—	*	*	—	—	—	—
1	*	*	*	*	*	*	*	*	—	—
1 1/4	*	*	*	*	*	*	*	*	*	—
1 1/2	*	*	*	*	*	*	*	*	*	—
1 3/4	*	*	*	*	*	*	*	*	*	—
2	*	*	*	*	*	*	*	*	*	*
2 1/4	*	—	*	—	*	*	*	*	*	*
2 1/2	*	—	*	—	*	*	*	*	*	*
2 3/4	*	—	*	—	*	*	—	*	*	*
3	*	—	*	—	*	*	*	*	*	*
3 1/4	*	—	*	—	—	*	—	*	*	*
3 1/2	*	—	*	—	—	*	—	*	*	*
4	—	—	*	—	—	*	—	*	*	*
4 1/2	—	—	*	—	—	*	—	*	*	*
5	—	—	*	—	—	*	—	*	*	*
5 1/2	—	—	—	—	—	*	—	*	*	*
6	—	—	—	—	—	*	—	*	*	*
6 1/2	—	—	—	—	—	*	—	*	*	*
7	—	—	—	—	—	*	—	*	*	*
8	—	—	—	—	—	*	—	*	*	*

***Call for current pricing**

Also Available:

**COMPLETE LINE OF
HOLO-KROME FASTENERS**

**CALL 1-800-544-7934 TO REQUEST
LATEST HOLO-KROME CATALOG**



WILLIAM T. HUTCHINSON CO.

TOLL FREE 1-800-544-7934 • 453 LEHIGH AVENUE • UNION, NEW JERSEY 07083-7928

www.hssblanks.com

LIXIE HAMMERS AND MALLETS

SOFT FACE DEAD BLOW

Hammers, Mallets and Sledges with Replaceable Faces

All Lixie Dead Blow striking tool head castings feature an unobstructed cavity, partially filled with iron shot. As the hammer is struck on a surface, the urethane face absorbs a portion of the blow's energy. The shot moves forward immediately behind the blow, dampening the rebound and insuring that the force of the blow is transmitted solidly to the struck surface. Lixie Dead Blow Hand Hammers and Mallets are available in 6 sizes, with a selection of two weights in each size. The rugged head casting is of either malleable iron (Heavy Dead Blow) or hi-tensile, non-sparking Aluminum (Light Dead Blow).

Lixie Dead Blow Sledges have the same features as the Hammers and Mallets. They are used where a heavy blow is desired, yet still retain the highly protective quality of Lixie urethane. They are available in 3 sizes with 2 weights in each size furnished with smooth hickory grip handles.

SEE PAGE 55 FOR AVAILABLE FACES



LIXIE
Dead
Blow
Sledge

LIXIE
Dead
Blow
Mallet

	MODEL	HEAD DIAM.	HEAD LENGTH	OVERALL LENGTH	WEIGHT (OUNCES)	PRICE EACH
HAMMERS & MALLETS	*100L-MH	1"	4-1/4"	11"	10	36.21
	100H-MH	1"	4-1/4"	11"	14	36.66
	*125L-MH	1-1/4"	4-7/8"	12"	14	40.07
	125H-MH	1-1/4"	4-7/8"	12"	22	39.74
	*150L-MH	1-1/2"	5-1/4"	13"	22	47.38
	150H-MH	1-1/2"	5-1/4"	13"	30	47.40
	*200L-MH	2"	6-1/4"	15"	38	66.02
	200H-MH	2"	6-1/4"	15"	56	65.05
	*250L-MH	2-1/2"	7"	17"	66	116.42
	250H-MH	2-1/2"	7"	17"	100	100.63
SLEDGES	*300L-MH	3"	8-1/2"	19"	116	157.24
	300H-MH	3"	8-1/2"	19"	168	149.16
	*250L-MH-32	2-1/2"	7-1/8"	32"	80	162.52
	250H-MH-32	2-1/2"	7-1/8"	32"	114	159.44
	*300L-MH-35	3"	8-1/2"	35"	120	206.61
300H-MH-35	3"	8-1/2"	35"	180	220.64	

HAMMERS FURNISHED COMPLETE WITH 2 FACES

Grade of face may be interchanged without increase in cost. Where not specified standard face makeup of Medium and Hard (MH) will be furnished.

*All L-Light Dead Blow models are sparkproof.

WILLIAM T. HUTCHINSON CO.

TOLL FREE 1-800-544-7934 • (908) 688-0533 • FAX (908) 688-8296 • ESTABLISHED 1927

www.hssblanks.com

LIXIE HAMMERS AND MALLETS

MULTI HAMMER

with Replaceable Urethane Face

ONE HAMMER DOES THE JOB OF TWO! With a flip of the wrist you can switch from a sparkproof bronze to a soft, protective urethane face without fumbling for another hammer. Lixie's exclusive all-purpose model has a machinist's head cast in our special bronze alloy, with the opposite face incorporating replaceable screw-in faces in your choice of 4 grades, soft to hard. The handle is Grade A hickory with an exclusive non-slip grooved handle and special epoxy wedge construction. The All-Purpose hammer comes in a choice of 3 sizes with face diameters of 1", 1-1/4" or 1-1/2".



MODEL	HEAD DIAM.	HEAD LENGTH	OVERALL LENGTH	WEIGHT (OUNCES)	PRICE EACH
AB 100-T	1"	3-7/8"	12-1/2"	16	43.10
AB 125-T	1-1/4"	4-3/8"	13"	26	53.88
AB 150-T	1-1/2"	5"	13"	36	73.80

HAMMERS FURNISHED COMPLETE WITH 1 URETHANE FACE

Grade of face may be interchanged without increase in cost. Where not specified standard Tough grade (T) will be furnished. All are sparkproof.

REPLACEABLE URETHANE SCREW-IN FACES

Lixie screw-type replaceable polyurethane faces are included on all Lixie Dead Blow and Multi Hammers. They are available in six sizes, with a range of four hardnesses in each size. This permits custom fitting a Lixie hammer to your individual requirements. Impervious to oils and most solvents, these solid polyurethane faces have high impact absorption, yet will not mar,peen or deform the struck surface.



COLOR DENOTES HARDNESS

COLOR	DIAMETER					
	1"	1-1/4"	1-1/2"	2"	2-1/2"	3"
BROWN (Soft)	6.93	7.69	9.38	12.67	23.14	31.40
GREEN (Medium)	6.93	7.69	9.38	12.67	23.14	31.40
RED (Tough)	6.93	7.69	9.38	12.67	23.14	31.40
BLACK (Hard)	9.22	10.33	12.67	18.53	33.89	46.87

NOTE: Order face diameter to coincide with hammer diameter. Faces packaged one each per container.

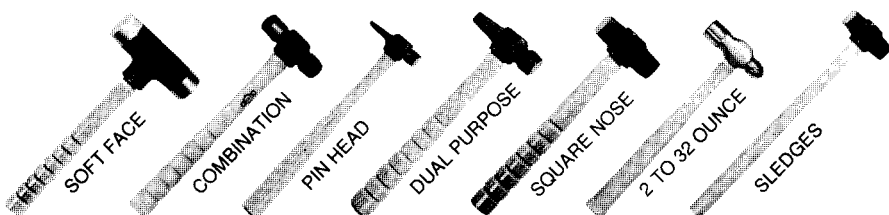

To request full line brochure of Lixie Hammers - Call 1-800-544-7934

WILLIAM T. HUTCHINSON CO.

TOLL FREE 1-800-544-7934 • 453 LEHIGH AVENUE • UNION, NEW JERSEY 07083-7928

STEEL SHIM STOCK

Steel Shim Stock is low carbon mild steel cold rolled to a #1 hard temper. It is stiff and springy. The material can be punched or sheared with minimum burring and distortion.

1008/1010 Full Hard, AISI1010, QQS 698

6" x 100" Rolls

THICKNESS	PRICE EACH
.001	\$ 13.08
.0015	15.54
.002	8.95
.0025	8.73
.003	11.33
.004	10.94
.005	10.00
.006	9.56
.007	9.96
.008	9.89
.009	10.36
.010	10.54
.012	10.33
.015	10.73
.018	12.19
.020	12.60
.025	13.46
.031	14.16

6" x 180" Rolls

THICKNESS	PRICE EACH
.001	\$ 27.07
.0015	32.19
.002	18.53
.0025	19.50
.003	23.64
.004	22.64
.005	20.67
.006	19.79
.007	20.63
.008	20.48
.009	21.43
.010	21.83
.012	21.39
.015	22.20
.018	25.27
.020	26.09
.025	27.86
.031	29.34

Assortments

12 Pak – 1 Pc. each 6"x12"		
\$ 39.33		
.001	.0015	.002
.003	.004	.005
.006	.007	.008
.010	.012	.015
15 Pak – 1 Pc. each 6"x12"		
\$ 45.82		
.001	.0015	.002
.003	.004	.005
.006	.007	.008
.010	.012	.015
.020	.025	.031
4 Pak – 1 Pc. each 6"x50"		
\$ 41.61		
.001		
.002		
.003		
.005		

BRASS SHIM STOCK

Use Brass Shim Stock where some stiffness is required and where corrosion problems exist. 70% copper and 30% zinc it has been cold rolled to a 1/2 hard temper, Rockwell hardness of 30T 56/68.

260 Half Hard

6" x 100" Rolls

THICKNESS	PRICE EACH
.001	\$ 22.64
.0015	22.74
.002	23.46
.003	24.23
.004	25.53
.005	26.41
.006	27.18
.007	28.52
.008	30.08
.009	32.32
.010	35.17
.012	38.09
.015	43.99
.020	51.58
.025	61.61
.031	72.89

6" x 180" Rolls

THICKNESS	PRICE EACH
.001	\$ 41.67
.0015	41.67
.002	41.67
.003	41.67
.004	43.74
.005	50.34
.006	54.78
.007	61.13
.008	61.13
.009	65.10
.010	65.10
.012	80.98
.015	89.53
.020	107.99
.025	129.42
.031	142.92

Assortments

12 Pak – 1 Pc. each 6"x12"		
\$ 45.65		
.001	.0015	.002
.003	.004	.005
.006	.007	.008
.010	.012	.015
15 Pak – 1 Pc. each 6"x12"		
\$ 62.25		
.001	.0015	.002
.003	.004	.005
.006	.007	.008
.010	.012	.015
.020	.025	.031
4 Pak – 1 Pc. each 6"x50"		
\$ 50.82		
.001		
.002		
.003		
.005		

WILLIAM T. HUTCHINSON CO.

TOLL FREE 1-800-544-7934 • (908) 688-0533 • FAX (908) 688-8296 • ESTABLISHED 1927

www.hssblanks.com

STAINLESS STEEL SHIM STOCK

Stainless Steel Shim Stock can be used in any applications where corrosion is a concern, Available as follows:

- 300 Series Full Hard, R/C 40-45
- 302 Half Hard, R/C 30-35
- 302 Annealed
- Stainless Steel Metric

300 Series Full Hard, R/C 40-45

6" x 50" Rolls

THICKNESS	PRICE EACH
.0005	\$ 69.18
.001	33.36
.0015	30.56
.002	21.11
.003	20.30
.004	19.80
.005	22.78
.006	22.75
.007	23.45
.008	23.84
.009	26.83
.010	24.74
.012	25.84
.015	27.96
.020	33.21
.025	38.89
.031	44.32

6" x 60" Rolls

THICKNESS	PRICE EACH
.001	\$ 48.04
.002	30.42
.003	29.21
.004	28.50
.005	32.79
.006	32.74
.007	33.77
.008	34.31
.009	38.74
.010	35.59
.012	37.21
.015	40.24
.020	46.40
.025	55.55
.031	63.83

12' x 50" Rolls

THICKNESS	PRICE EACH
.001	\$ 66.14
.002	41.91
.003	41.64
.004	42.47
.005	46.15
.006	52.37
.007	54.12
.008	55.08
.010	56.25
.012	58.73
.015	58.84
.020	64.03
.025	77.01
.031	101.31

1/2 Hard Stainless Shim R/C 30-35 AISI 302

12" x 50" Rolls

THICKNESS	PRICE EACH
.003	\$ 87.94
.004	94.41
.005	95.42
.006	116.47
.008	122.43
.010	134.61
.012	130.63
.015	124.31
.020	135.27
.025	171.27

Annealed Stainless Shim AISI 302

12" x 50" Rolls

THICKNESS	PRICE EACH
.003	\$ 87.94
.004	94.41
.005	95.42
.006	116.47
.008	122.43
.010	134.61
.012	130.63
.015	124.31
.020	135.27
.025	171.27

Metric Stainless

300 Series Full Hard, R/C 40-45

150mm x 1.25m

THICKNESS	PRICE EACH
.05 mm	\$ 22.25
.10	22.63
.15	23.86
.20	25.02
.25	25.94
.30	27.09
.40	29.36
.50	34.85
.65	40.82
.80	46.51

WILLIAM T. HUTCHINSON CO.

TOLL FREE 1-800-544-7834 • 453 LEHIGH AVENUE • UNION, NEW JERSEY 07083-7828

AISI TYPE 0-1 OIL HARDENING GROUND FLAT STOCK

Overall Length: 18"

Thickness	Width	Price Each	Thickness	Width	Price Each	Thickness	Width	Price Each	Thickness	Width	Price Each	
1/64	1/2	93.01	5/64	1/2	13.64	1/8	3	42.66	3/16	3-1/2	60.87	
	3/4	96.71		3/4	16.89		3-1/2	48.58		4	68.02	
	1	142.61		1	20.19		4	54.49		5	82.53	
	1-1/4	106.46		1-1/4	23.40		5	66.31		6	97.00	
	1-1/2	117.25		1-1/2	26.69		6	78.14		8	144.24	
	2	145.66		2	33.26		7	103.20		10	177.41	
	2-1/2	167.00		2-1/2	39.53		8	116.96		12	210.85	
	3	200.08		3	46.12		10	144.19		7/32	7/32	24.71
	4	269.40		4	59.37		12	171.56			1/2	21.18
		6	85.91	14	198.14	3/4	25.51					
1/32	1/2	16.87	3/32	1/4	44.11	9/64	1/2	16.36	1	29.86		
	3/4	22.79		3/8	24.21		3/4	18.64	1-1/4	33.91		
	1	26.56		1/2	13.64		1	22.08	1-1/2	38.24		
	1-1/4	31.48		3/4	16.89		1-1/4	26.56	2	46.89		
	1-1/2	36.39		1	20.19		1-1/2	28.67	2-1/2	55.94		
	2	46.01		1-1/4	23.40		2	35.50	3	64.16		
	2-1/2	55.74		1-1/2	26.69		3	49.05	4	81.39		
	3	65.72		1-3/4	29.97		4	62.60	6	115.91		
	4	85.11		2	33.26		5/32	5/32	26.74	1/4	1/4	23.04
6	150.30	2-1/2	39.86	1/4	40.00	5/16		35.26				
3/64	1/2	14.81	3	46.46	3/8	23.22		3/8	18.03			
	3/4	19.08	4	59.58	1/2	16.21		1/2	19.65			
	1	23.26	5	72.73	3/4	19.87		5/8	21.60			
	1-1/4	27.30	6	85.86	1	23.49		3/4	23.45			
	1-1/2	31.50	8	128.41	1-1/4	26.90		1	27.33			
	2	39.91	10	230.17	1-1/2	30.44		1-1/4	30.84			
	2-1/2	48.14	7/64	1/2	16.22	1-3/4		34.06	1-1/2		34.74	
	3	56.50		3/4	20.15	2	37.72	1-3/4	38.27			
	3-1/2	64.86		1	23.96	2-1/2	44.84	2	42.39			
4	88.54	1-1/4		27.69	3	52.09	2-1/2	50.04				
6	106.31	1-1/2		31.60	3-1/2	59.30	3	57.70				
1/16	1/4	35.02		2	39.37	4	66.50	3-1/2	65.38			
	3/8	17.50		2-1/2	49.27	5	80.94	4	73.06			
	1/2	10.44		3	54.85	6	95.30	4-1/2	80.70			
	5/8	11.99		4	70.33	8	142.11	5	88.35			
	3/4	13.19	6	110.99	3/16	3/16	25.72	5-1/2	96.06			
	1	15.90	1/8	1/8		28.81	1/4	14.20	6	107.88		
	1-1/4	18.56		1/4		10.36	5/16	15.39	7	136.45		
	1-1/2	21.32		5/16		11.30	3/8	16.07	8	154.37		
	1-3/4	24.01		3/8		11.94	1/2	17.69	10	189.63		
2	26.74	1/2		13.17		5/8	19.87	12	225.07			
2-1/2	32.13	5/8		14.66		3/4	21.20	14	259.44			
3	37.52	3/4		16.19		1	24.85	9/32	9/32	23.96		
3-1/2	43.06	1		19.14		1-1/4	28.24		1/2	22.70		
4	48.35	1-1/4		21.94	1-1/2	31.87	3/4		27.01			
5	59.23	1-1/2	24.88	1-3/4	35.46	1	31.41					
6	70.07	1-3/4	27.87	2	39.12	1-1/4	35.37					
8	105.05	2	30.82	2-1/2	46.32	1-1/2	39.78					
10	129.86	2-1/2	36.71	3	53.60							

Tolerance: Thickness ± .001
 Width + .005
 - .0

Also Available:

36" Lengths • Oversize • Low Carbon • A-2, D-2, S-7

WILLIAM T. HUTCHINSON CO.

TOLL FREE 1-800-544-7934 • (908) 688-0533 • FAX (908) 688-8296 • ESTABLISHED 1927

www.hssblanks.com

AISI TYPE 0-1 OIL HARDENING GROUND FLAT STOCK

Overall Length: 18"

Thickness	Width	Price Each	Thickness	Width	Price Each	Thickness	Width	Price Each	Thickness	Width	Price Each			
9/32	2	48.46	7/16	1-1/4	52.67	3/4	2	103.02	1-1/2	2	185.34			
	3	65.85		1-1/2	59.01		2-1/2	120.59		3	215.11			
	4	83.19		2	71.64		3	138.26		4	257.20			
	6	117.84		2-1/2	84.31		3-1/2	155.83		5	310.28			
5/16	5/16	24.91		3	96.96		4	173.43		6	429.72	2	2	237.44
	3/8	21.69		4	119.21		4-1/2	191.04		8	594.79		3	312.29
	1/2	23.52	6	172.91	5		209.64	2-1/2		2	408.19			
	5/8	25.81	1/2	1/2	35.26		6			244.83	3		387.22	
	3/4	28.04		5/8	38.55		8		358.19	4	515.50			
	1	32.59		3/4	41.84		10		432.00	6				
	1-1/4	36.69		1	48.39		12		505.86					
	1-1/2	41.25		1-1/4	54.74		7/8		7/8	74.48				
	1-3/4	45.73		1-1/2	61.27	1		79.51						
	2	50.27	1-3/4	68.06	1-1/4	88.93								
	2-1/2	59.30	2	74.45	1-1/2	98.91								
	3	68.29	2-1/2	87.60	2	118.87								
3-1/2	77.31	3	100.76	3	158.94									
4	86.36	3-1/2	113.90	4	198.94									
5	104.21	4	127.08	6	279.95									
6	126.94	4-1/2	140.24	1	1	85.50								
7	160.64	5	154.29		1-1/4	95.31								
8	181.49	6	196.31		1-1/2	105.84								
10	222.79	7	239.16		1-3/4	116.31								
12	264.36	8	270.09		2	126.81								
3/8	3/8	31.34	10		325.11	2-1/2	147.83							
	1/2	28.67	12		379.58	3	168.76							
	5/8	31.44	9/16		9/16	42.31	3-1/2	189.76						
	3/4	34.19			3/4	47.72	4	210.74						
	1	39.60			1	55.01	5	253.69						
	1-1/4	44.60			1-1/4	62.16	6	295.71						
	1-1/2	50.06			1-1/2	69.42	8	431.21						
	1-3/4	57.14		2	84.06	10	520.46							
	2	60.99	5/8	5/8	46.19	12	609.64							
	2-1/2	71.83		3/4	50.00	1-1/8	1-1/8	109.02						
	3	82.75		1	57.53		1-1/2	126.96						
	3-1/2	93.67		1-1/4	64.84		2	150.99						
4	104.54	1-1/2		72.39	3		199.00							
4-1/2	115.41	2		87.50	4		247.07							
5	126.26	2-1/2	102.59	6	344.21									
5-1/2	137.24	3	117.71	1-1/4	1-1/4	120.38								
6	148.09	3-1/2	132.85		1-1/2	133.34								
7	194.19	4	147.95		2	159.38								
8	219.42	5	179.15		2-1/2	185.31								
10	269.34	6	209.37		3	211.19								
12	319.53	3/4	3/4		59.44	4	263.08							
7/16	7/16		37.81	1	68.29	5	316.01							
	1/2		34.19	1-1/4	76.62	6	367.91							
	3/4		40.51	1-1/2	85.41	1-1/2	1-1/2	155.59						
	1		46.83	1-3/4	94.22									

Tolerance:

Thickness ± .001
Width + .005
- .0

Also Available:

- 36" Lengths
- Oversize
- Low Carbon
- A-2, D-2, S-7

WILLIAM T. HUTCHINSON CO.

TOLL FREE 1-800-544-7834 • 453 LEHIGH AVENUE • UNION, NEW JERSEY 07083-7828

www.hssblanks.com

SOLID CARBIDE PLAIN PRESS FIT BUSHINGS

Std. Drill Size A	Actual O.D. B	Length C	Symbol for O.D. Finish Ground
.0135 to .0625	.1578 .1575	1/4	PC-10-4
		5/16	PC-10-5
		3/8	PC-10-6
		1/2	PC-10-8
.0625 to .0995	.2046 .2043	1/4	PC-13-4
		5/16	PC-13-5
		3/8	PC-13-6
		1/2	PC-13-8
.0980 to .1406	.2516 .2513	1/4	PC-16-4
		5/16	PC-16-5
		3/8	PC-16-6
		1/2	PC-16-8
.1250 to .1935	.3141 .3138	3/4	PC-16-12
		1	PC-20-4
		5/16	PC-20-5
		3/8	PC-20-6
.1875 to .2570	.4078 .4075	1/2	PC-20-8
		3/4	PC-20-12
		1	PC-20-16
		1-3/8	PC-26-4
.1875 to .3160	.5017 .5014	5/16	PC-26-5
		3/8	PC-26-6
		1/2	PC-26-8
		3/4	PC-26-12
.3125 to .4375	.6267 .6264	1	PC-26-16
		1-3/8	PC-26-22
		1-3/4	PC-26-28
		2-1/8	PC-26-34
.3750 to .5312	.7518 .7515	1	PC-32-6
		1-3/8	PC-32-8
		1-3/4	PC-32-12
		2-1/8	PC-32-16
.5000 to .6250	.8768 .8765	1-3/4	PC-32-22
		2-1/8	PC-32-28
		1/2	PC-32-34
		3/4	PC-40-6
.6250 to .7500	1.0018 1.0015	1	PC-40-8
		1-3/8	PC-40-12
		1-3/4	PC-40-16
		2-1/8	PC-40-22
.7500 to 1.0000	1.3772 1.3768	1-3/4	PC-40-28
		2-1/8	PC-40-34
		1/2	PC-48-8
		3/4	PC-48-12
		1	PC-48-16
		1-3/8	PC-48-22
		1-3/4	PC-48-28
		2-1/8	PC-48-34
		1/2	PC-56-8
		3/4	PC-56-12
		1	PC-56-16
		1-3/8	PC-56-22
		1-3/4	PC-56-28
		2-1/8	PC-56-34
		1/2	PC-64-8
		3/4	PC-64-12
		1	PC-64-16
		1-3/8	PC-64-22
		1-3/4	PC-64-28
		2-1/8	PC-64-34
		2-1/2	PC-64-40
		3/4	PC-88-12
		1	PC-88-16
		1-3/8	PC-88-22
		1-3/4	PC-88-28
		2-1/8	PC-88-34
		2-1/2	PC-88-40

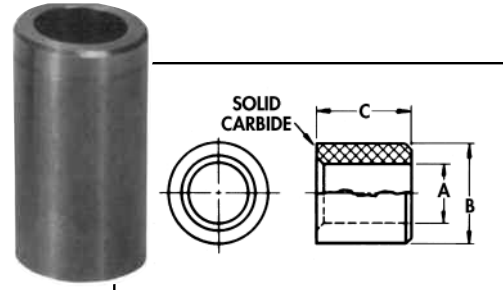

SOLID CARBIDE SLIP & FIXED RENEWABLE BUSHINGS

ALSO AVAILABLE
PRICES UPON REQUEST

STANDARD I.D. TOLERANCES

Up to 1/4	Nominal +.0001/+ .0004
Over 1/4 to 3/4	Nominal +.0001/+ .0005
Over 3/4 to 1-1/2	Nominal +.0002/+ .0006
Over 1-1/2 to 1-3/4	Nominal +.0003/+ .0007

Counterbore

Unless otherwise specified, all Carbide Bushings are supplied without counterbore. (Carbide Bushings with counterbore are priced as specials.)

AVAILABLE IN DRILL SIZES
UP TO 1.750
PRICES ON REQUEST

WILLIAM T. HUTCHINSON CO.

TOLL FREE 1-800-544-7934 • (908) 688-0533 • FAX (908) 688-8296 • ESTABLISHED 1927

www.hssblanks.com

CARBIDE HEAD PRESS FIT BUSHINGS

Std. Drill Size A	Actual O.D. B	Length C	Symbol for O.D. Finish Ground	HEAD DIMENSIONS	
				F	G
.0135 to .0625	.1578 .1575	1/4 5/16 3/8 1/2	HC-10-4 HC-10-5 HC-10-6 HC-10-8	1/4	3/32
.0625 to .0995	.2046 .2043	1/4 5/16 3/8 1/2	HC-13-4 HC-13-5 HC-13-6 HC-13-8	19/64	3/32
.0980 to .1406	.2516 .2513	1/4 5/16 3/8 1/2 3/4	HC-16-4 HC-16-5 HC-16-6 HC-16-8 HC-16-12	23/64	3/32
.1250 to .1935	.3141 .3138	1/4 5/16 3/8 1/2 3/4 1	HC-20-4 HC-20-5 HC-20-6 HC-20-8 HC-20-12 HC-20-16	27/64	1/8
.1875 to .2570	.4078 .4075	1/4 5/16 3/8 1/2 3/4 1 1-3/8	HC-26-4 HC-26-5 HC-26-6 HC-26-8 HC-26-12 HC-26-16 HC-26-22	1/2	5/32
.1875 to .3160	.5017 .5014	3/8 1/2 3/4 1 1-3/8 1-3/4	HC-32-6 HC-32-8 HC-32-12 HC-32-16 HC-32-22 HC-32-28	39/64	7/32
.3125 to .4375	.6267 .6264	3/8 1/2 3/4 1 1-3/8 1-3/4 2-1/8	HC-40-6 HC-40-8 HC-40-12 HC-40-16 HC-40-22 HC-40-28 HC-40-34	51/64	7/32
.3750 to .5312	.7518 .7515	1/2 3/4 1 1-3/8 1-3/4 2-1/8	HC-48-8 HC-48-12 HC-48-16 HC-48-22 HC-48-28 HC-48-34	59/64	7/32
.5000 to .6250	.8768 .8765	1/2 3/4 1 1-3/8 1-3/4 2-1/8	HC-56-8 HC-56-12 HC-56-16 HC-56-22 HC-56-28 HC-56-34	1-7/64	1/4
.6250 to .7500	1.0018 1.0015	1/2 3/4 1 1-3/8 1-3/4 2-1/8 2-1/2	HC-64-8 HC-64-12 HC-64-16 HC-64-22 HC-64-28 HC-64-34 HC-64-40	1-15/64	5/16
.7500 to 1.0000	1.3772 1.3768	3/4 1 1-3/8 1-3/4 2-1/8 2-1/2	HC-88-12 HC-88-16 HC-88-22 HC-88-28 HC-88-34 HC-88-40	1-39/64	3/8

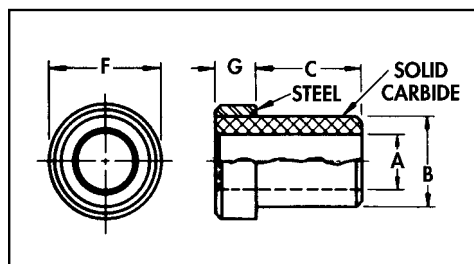

SOLID CARBIDE SLIP & FIXED RENEWABLE BUSHINGS

ALSO AVAILABLE
PRICES UPON REQUEST

STANDARD I.D. TOLERANCES

Up to 1/4	Nominal +.0001/+.0004
Over 1/4 to 3/4	Nominal +.0001/+.0005
Over 3/4 to 1-1/2	Nominal +.0002/+.0006
Over 1-1/2 to 1-3/4	Nominal +.0003/+.0007

AVAILABLE IN DRILL SIZES
UP TO 1.750
PRICES ON REQUEST

WILLIAM T. HUTCHINSON CO.

TOLL FREE 1-800-544-7934 • 453 LEHIGH AVENUE • UNION, NEW JERSEY 07083-7928

STEEL FEELER GAGE STOCK

Thickness	Strips 1/2 x 12"	Coils 1/2 x 25'	Thickness	Strips 1/2 x 12"	Coils 1/2 x 25'
.001	\$4.67	\$93.43	.039	2.16	43.20
.0015	2.50	49.92	.040	2.16	43.20
.002	2.50	49.92	.041-.045	8.57	AVAILABLE IN .001 INCREMENTS — NOT AVAILABLE IN COIL
.0025	2.56	51.21	.046-.055	9.29	
.003	2.50	49.92	.056-.065	10.00	
.004	2.03	40.64	.066-.075	10.36	
.005	2.03	36.57	.076-.090	10.72	
.006	2.03	36.57	.091-.125	11.43	
.007	1.79	32.26			
.008	1.79	32.26			
.009	1.79	32.26			
.010	1.79	32.26			
.011	1.79	32.26			
.012	1.79	32.26			
.013	1.79	32.26			
.014	1.79	32.26			
.015	1.79	32.26			
.016	1.79	32.26			
.017	1.79	32.26			
.018	1.79	32.26			
.019	1.79	32.26			
.020	1.79	32.26			
.021	1.79	32.26			
.022	1.79	32.26			
.023	1.79	32.26			
.024	1.79	32.26			
.025	1.79	32.26			
.026	1.79	35.84			
.027	1.79	35.84			
.028	1.79	35.84			
.029	1.79	35.84			
.030	1.79	35.84			
.031	1.92	38.40			
.032	1.92	38.40			
.033	1.92	38.40			
.034	1.92	38.40			
.035	1.92	38.40			
.036	2.16	43.20			
.037	2.16	43.20			
.038	2.16	43.20			



TOLERANCE FOR
.020 & LARGER = \pm .0005
FOR .019 & SMALLER
SEE PAGE 63

Steel gage stock is made from fine quality 1095 tempered spring steel and etched every six inches for positive identification.

Available in 1/2" wide (12.7 MM) twelve inch (300 MM) lengths or 25' (7.62 M) rolls

Additional sizes and materials available. Call for pricing and delivery.

Metric - Steel		
Thickness	Strips 12.7mm x 300 mm	Coils 12.7mm x 7.62m
.04mm	\$ 4.64	\$ 99.99
.05	4.29	92.86
.06	3.93	85.71
.07	3.57	78.57
.08	3.57	78.57
.09	3.35	71.43
.10	3.35	71.43
.15	3.22	67.86
.20	3.22	67.86
.25	3.22	67.86
.30	3.22	67.86
.35	3.22	67.86
.40	3.22	67.86
.45	3.22	67.86
.50	3.22	67.86
.55	3.29	69.29
.60	3.29	69.29
.65	3.29	69.29
.70	3.28	69.29
.75	3.29	69.29
.80	3.36	71.43
.85	3.36	71.43
.90	3.36	71.43
.95	3.36	71.43
1.00	3.36	71.43
1.50	10.72	—
2.00	11.43	—
2.50	12.14	—
3.00	12.14	—

WILLIAM T. HUTCHINSON CO.

TOLL FREE 1-800-544-7934 • (908) 688-0533 • FAX (908) 688-8296 • ESTABLISHED 1927

STAINLESS STEEL FEELER GAGE STOCK

STAINLESS STEEL GAGE STOCK IS TYPE 301 EXTRA FULL HARD OR HIGH YIELD, WITH A #1 ROUND EDGE. LIKE THE STEEL STOCK IT IS ETCHED EVERY SIX INCHES FOR POSITIVE IDENTIFICATION.

AVAILABLE IN 1/2" AND 1" WIDTHS, TWELVE INCH LENGTHS OR 25' ROLLS.

SPECIAL LENGTHS, WIDTHS AND THICKNESS ON REQUEST.

Thickness	STRIPS 1/2 x 12"	COILS 1/2 x 25'	STRIPS 1 x 12"	COILS 1 x 25'	TOLERANCE +/-
.0005	\$7.73	\$154.63	\$15.46	\$321.43	.00005
.001	6.08	121.32	12.13	242.63	.00012
.0015	4.21	110.75	8.43	168.57	.00012
.002	3.64	72.86	7.28	145.72	.00016
.0025	4.64	92.71	9.27	185.43	.00016
.003	3.64	72.86	7.28	145.72	.00020
.004	2.78	55.32	5.53	110.63	.00020
.005	2.78	49.79	5.53	99.57	.00024
.006	2.78	49.79	5.53	99.57	.00028
.007	2.78	49.79	5.53	99.57	.00028
.008	2.78	49.79	5.53	99.57	.00031
.009	2.78	49.79	5.53	99.57	.00031
.010	2.78	49.79	5.53	99.57	.00035
.011	3.01	54.26	6.03	108.52	.00035
.012	3.01	54.26	6.03	108.52	.00035
.013	3.01	54.26	6.03	108.52	.00043
.014	3.01	54.26	6.03	108.52	.00043
.015	3.01	54.26	6.03	108.52	.00043
.016	3.31	61.72	Not Available in Coils		.00047
.017	3.31	61.72			.00047
.018	3.31	61.72			.00047
.019	3.31	61.72			.00047
.020	3.31	61.72			.00050
.021	3.87	69.59			.00050
.022	3.87	69.59			.00050
.023	3.87	69.59			.00050
.024	3.87	69.59			.00050
.025	3.87	69.59			.00050
.031	3.87	69.59			.00050

WILLIAM T. HUTCHINSON CO.

TOLL FREE 1-800-544-7834 • 453 LEHIGH AVENUE • UNION, NEW JERSEY 07083-7828